

# BONITOR

fine mini projector

## MP201 User Guide



PlayStation

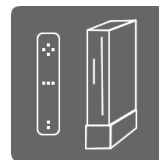

Wii

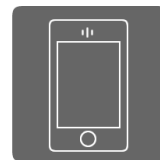

Made for iPhone

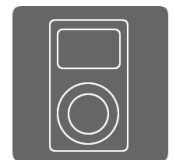

Made for iPod



Nokia 5800



Cowon O2



DVD Player

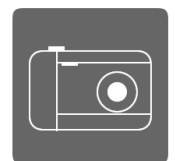

Camcorder

## User Guide Menu

---

Overview	3
Specifications	4
Compatibility	5
Operating Instructions	6-7
Trouble Shooting	8
Safety Statements	9

---

## Overview

---

Bonitor MP201 is a portable mini projector powered by both long-life rechargeable li-ion battery and dc power. It works with most of the devices with video output capability to project videos anywhere. Typical examples are game consoles, dvd and blueray disc player, mobile phone, portable media player.

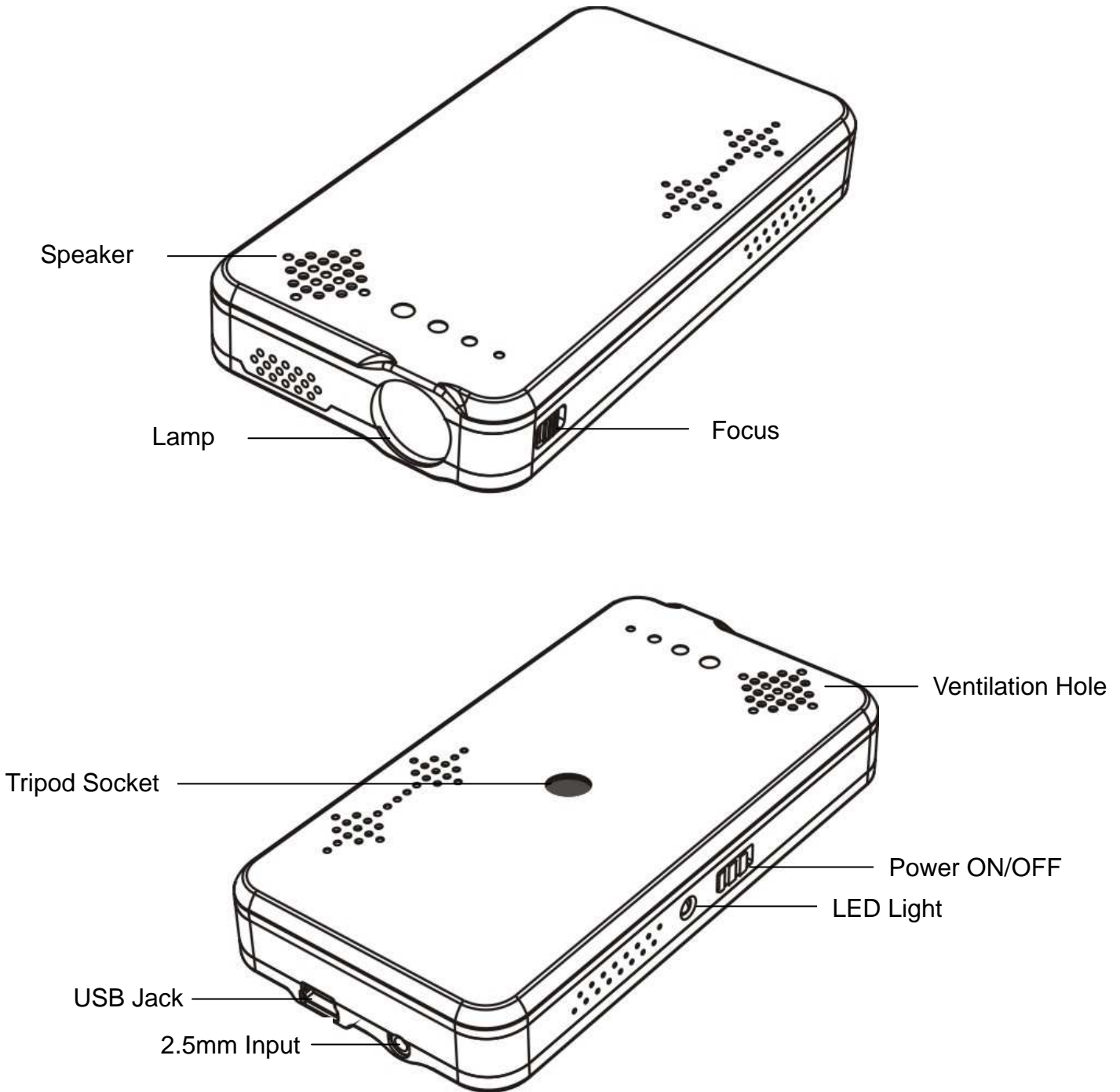

## Specifications

---

Description	Parameter
Display Technology	LCOS
Native Resolution	640 x 480 pixels
Aspect Ratio	4 : 3
Brightness	15 lumens
Throw Ratio	1.57
Projection Distance	195 - infinite
Image Size	124.5 - infinite / 4.9" - infinite
Light Source	LED
LED Lifetime	>30,000 hours
Inputs	Composite Video, DC Power
Input Signal	NTSC, PAL, SECAM
Refresh Rate	50 Hz / 60 Hz
Input Resolution	VGA, SVGA, XGA
Dimension	60 x 113 x 18 mm
Weight	160 grams
Tripod Socket	¼" - 20
Operating Temperature	10° - 27°C / 50° - 80°F
Speaker	Built-in stereo 0.5W / 4ohm x 2
Battery	Rechargeable Li-ion 3.7v - 2500mAh
Battery Life	>2 hours

## Compatibility

---

Bonitor MP201 connects devices with AV output capability, including game consoles, mobile phones, portable media players and more. Here are some officially verified popular examples (Compatibility of MP201 is not limited to the examples below and the functionality is not guaranteed due to the possibility of different setups and environments.):

Category	Model
Game Consoles	Sony Playstation 2
	Sony Playstation 3
	Sony PSP
	Microsoft Xbox 360
	Nintendo Wii
Mobile Phones	Apple iPhone
	Nokia N79
	Nokia N95
	Nokia N96
	Nokia 5800XM
Portable Media Players	Apple iPod Touch
	Apple iPod Classic
	Apple iPod Nano
Others	DVD Player
	Digital Video Camcorder
	Digital Camera

# Operating Instructions

---

## Recharging MP201

Slide the power switch to OFF mode and recharge MP201 with the included AC adaptor / charger. LED light flashes once per second during recharging. Full recharge takes probably 4-5 hours. LED light will stop flashing once the battery is fully recharged.

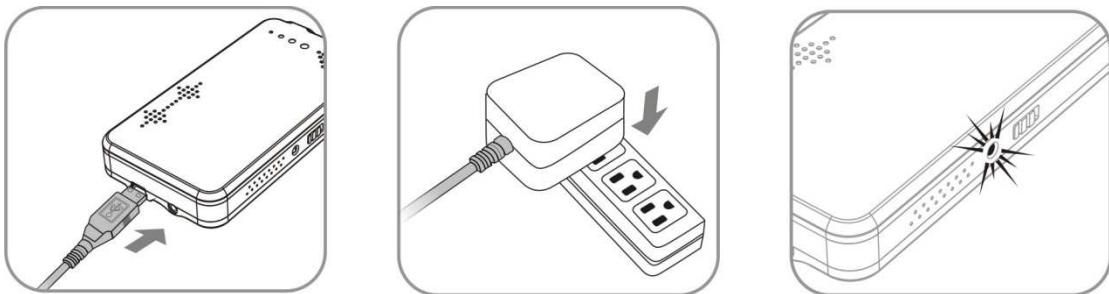

## Functioning MP201

### 1. Connecting a device

MP201 auto-detect video signals from an external video device with correct cable connection. (1) Connect the included RCA cable to MP201. (2) Connect another RCA cable to your video device. (3) Connect two RCA cables with the included RCA adaptor.

### 2. Turning to video output mode

Manual settings should be required for your video device. Turn your video device to video output mode. If you have problems on turning it to video output mode, please consult the documentation of your video device or the manufacturer.

### 3. Powering on

Slide the power switch of MP201 to ON mode. The LED light will turn on and project the detected signals. If no video signal is detected, MP201 will not project anything and the LED light will flash twice per second.

## LED Light

LED light indicates the situations of MP201. Learn more indications from LED light mode.

Situations	LED light mode
Projecting	LED light turns on without flashing
Recharging	LED light flashes once per second
No Signal	LED light flashes twice per second
Low Power	LED light flashes ten times per second
Overheat	LED light flashes ten times per second

## Image Size

Distance between MP201 and the display decides the image size. The following table gives a quick reference for the relationship.

Distance	Image Size
9 Inch	5.7 Inch
16 Inch	10.2 Inch
32 Inch	20.4 Inch
80 Inch	50.9 Inch
118 Inch	75.2 Inch

## Focus Adjustment

Rotate the focus wheel until the projected image is satisfactory.

## Trouble Shooting

---

Slide the power switch to OFF mode and recharge MP201 with the included AC adaptor / charger. LED light flashes once per second during recharging. Full recharge takes probably 4-5 hours. LED light will stop flashing once the battery is fully recharged.

Situations	Problems and Solutions
No Projection	<ol style="list-style-type: none"><li>1. Power is off Turn the projector on</li><li>2. No input signal Turn your video device to video output mode</li></ol>
Blurred Image	<ol style="list-style-type: none"><li>1. Not focused Rotate the focus wheel until the projected image is satisfactory</li><li>2. Out of range Place MP201 within the distance range</li></ol>

---



## Safety Statements

---

### CE Statement

This product is herewith confirmed to comply with applicable directive 2004/108/EC Electromagnetic Compatibility (as amended) in accordance with European Union Rules.

The equipment was passed. The test was performed according to the following applicable standards:

EMC

EN 55022: 2006

EN55024: 1998+A1: 2001+A2: 2003

EN61000-3-2: 2006

EN61000-3-3: 1995+A1: 2001+A2: 2005

### FCC Statement Class B

This equipment has been tested and found to comply with the limits for a class B digital device, pursuant to Part 15 of the FCC rules. These limits are designed to provide reasonable protection against harmful interference in a residential installation. This equipment generates uses and can radiate radio frequency energy and, if not installed and used in accordance with the instructions, may cause harmful interference to radio communications. However, there is no guarantee that interference will not occur in a particular installation. If this equipment does cause harmful interference to radio or television reception, which can be determined by turning the equipment off and on, the user is encouraged to try to correct the interference by one or more of the following measures:

- Reorient or relocate the receiving antenna
- Increase the separation between the equipment and receiver
- Connect the equipment to an outlet on a circuit different from that to which the receiver is connected
- Consult the dealer or an experienced radio/TV technician for help